

980nm 10mw~15mw SM Coaxial Pigtailed Laser Diode with 9um SMF28 | Built-in Photodiode
976nm~980nm SM Fiber Coupled LD with Single Mode Fiber (9um SM Fiber) | With PD
WSLP-980-015m-9-PD
Wavespectrum Laser Group
www.wavespectrum-laser.com

980nm Pigtailed Diode Laser		15mW/SMF28 Fiber		Wavespectrum Laser Group	
PARAMETER	SYMBOL	VALUE	UNIT		
Reverse Voltage	V_r	2.0		V	
Operating Temperature	T_{op}	-10~+40		°C	
Storage Temperature	T_{stg}	-15~+85		°C	
Lead soldering temperature (5 sec.)	T_{is}	250		°C	
Features: <ul style="list-style-type: none"> ● 980nm ● 9um Fiber ● Coaxial Package ● Built-in PD 					
Applications: <ul style="list-style-type: none"> ● Medical laser treatment ● Sensor ● Others 					
Specifications	WSLP-980-015m-9-PD				
	Min	Type	Max		
Center Wavelength@25°C	±3nm	980nm	±10nm		
Recommend Operating Temperature	25°C				
Output Power	10mw	15mw	----		
Fiber Type	SMF28				
Fiber Core	9um				
Monitor Current	----	0.5mA	----		
PD Reverse Voltage	----	30V	----		
Fiber Connector	FC				
Fiber Length	----	80cm	100cm		
Threshold Current (Typ.)	----	15mA	30mA		
Operating Current (Typ.)	----	80mA	100mA		
Operating Voltage	----	1.6V	2.2V		
Package Style	Coaxial				
Photodiodes	Built-in				

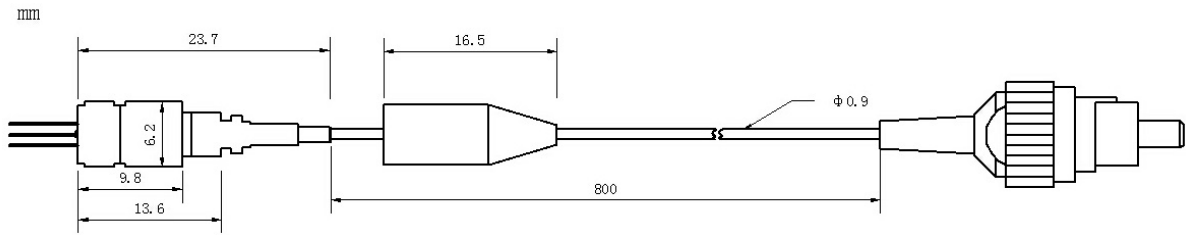

Coaxial Package View



PIN Bottom View:

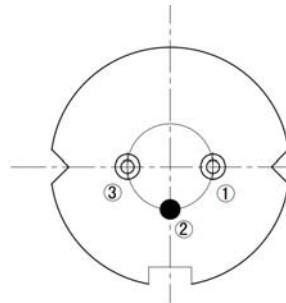

1	LD(-)
2	LD(+)&PD(-)
3	PD(+)

Electrically shorten LD module and store in non-extreme conditions.
 Suggest using the constant current power supply.

