

1410nm DFB 2mw Coaxial Pigtail Laser Diode with SMF
1410nm Fiber Coupled LD with Single Mode Fiber (SM Fiber)

WSLP-1410-002m-9-DFB

Wavespectrum laser Group

www.wavespectrum-laser.com

PARAMETER	SYMBOL	VALUE	UNIT	
LD Reverse Voltage	V_r	2.0	V	
PD Operating Current	$I_{r(PD)}$	2.0	mA	
PD Reverse Voltage	$V_{r(PD)}$	15	V	
Operating Temperature	T_{op}	-10 ~ +85	°C	
Storage Temperature	T_{stg}	-40 ~ +85	°C	
Lead soldering temperature (10 sec.)	T_{is}	260	°C	
Features: <ul style="list-style-type: none"> ● 1410nm ● DFB Laser Diode ● Built-in Photodiodes ● 9um SM Fiber ● Isolator Optional ● Coaxial or Receptacle Package Optional 				
Applications: <ul style="list-style-type: none"> ● Test Equipments ● Optical Transmitter of Analog Signal ● Optical Transmitter of Data Signal 				
Specifications		WSLP-1410-002m-9-DFB		
		Min	Type	Max
Center Wavelength@25°C		+/-2nm	1410nm	+/-3nm
Laser Type		DFB		
Output Power		----	2mW	----
Fiber Core		9um SM Fiber		
Threshold Current (Typ.) I_{th}		5mA	11mA	15mA
Operating Current		----	30mA	35mA
Forward Voltage		----	1.1V	1.6V
Monitor Current		0.1mA	----	----
PD Capacitance		----	10pF	15pF
PD Dark Current		----	----	0.1uA
Side Mode Suppression Ration		30dB	35dB	----
Package Style		Coaxial (Receptacle Optional)		
Data Rate		1.25Gb/s		
Isolator		Optional		
Connector Pin		A-type (B-type Optional)		
Fiber Connector		FC		



Coaxial Package View

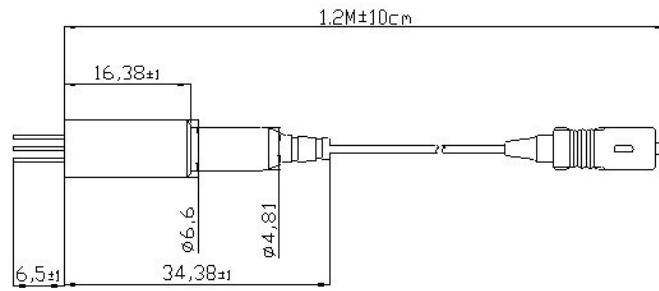

Bottom View

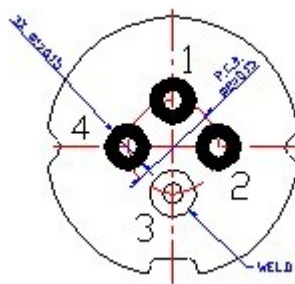

TYPE A
PIN ASSIGNMENT:

1	PD Cathode
2	PD Anode
3	LD Anode, GND
4	LD Cathode

Electrically shorten LD module and store in non-extreme conditions.
Suggest using the constant current power supply.

